

FORD AXOD/E (AX4S) AX4S-HO OVERDRIVE

A ▶

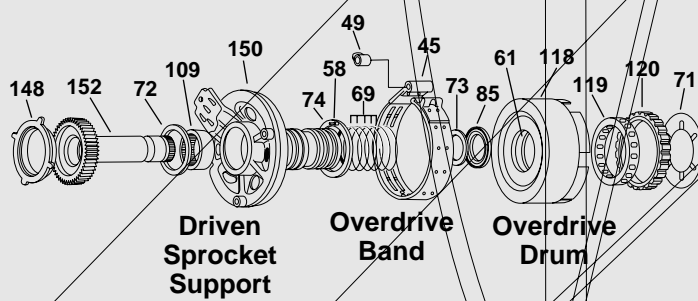

B ▶

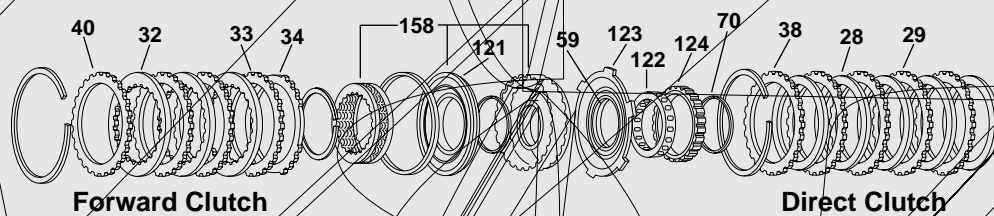

C ▶

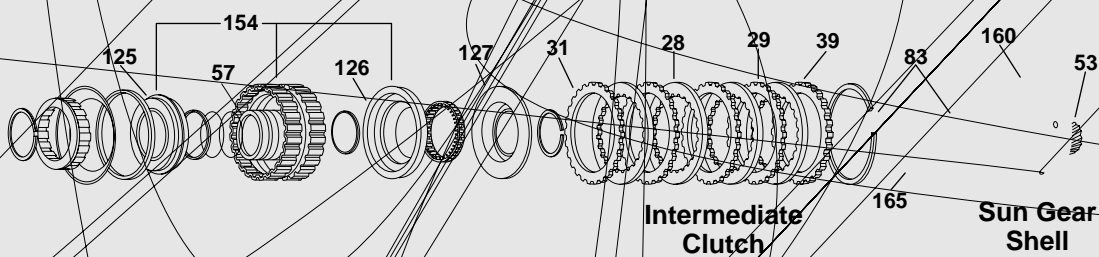

95-Up, 36 Lug Components

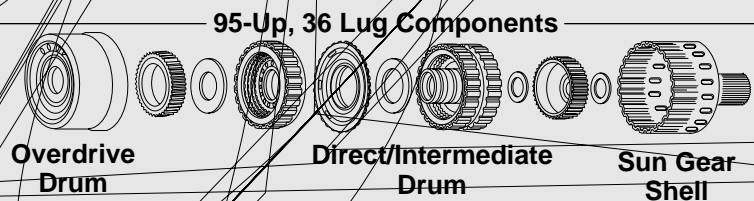

D ▶

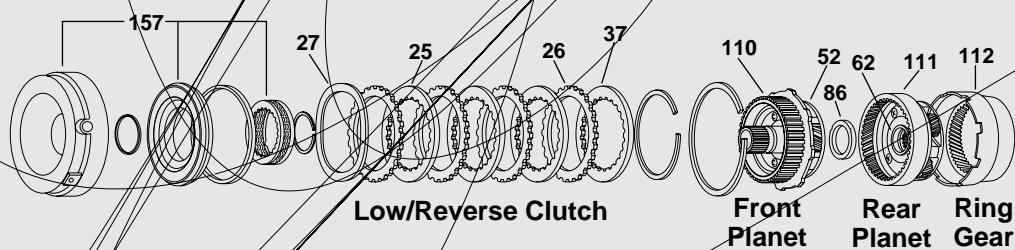

E ▶

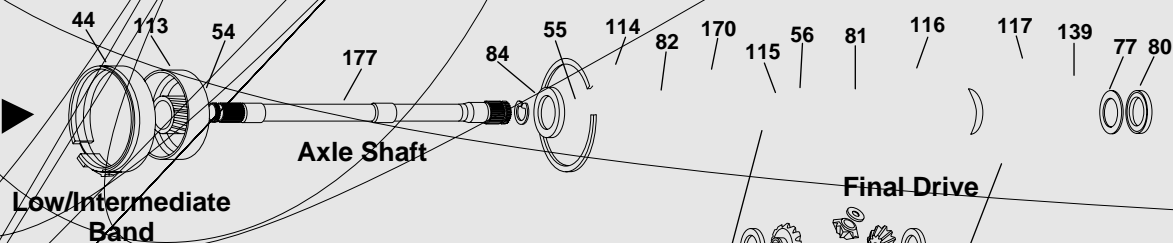

FORD AXOD/E (AX4S)
AX4S-HO OVERDRIVE

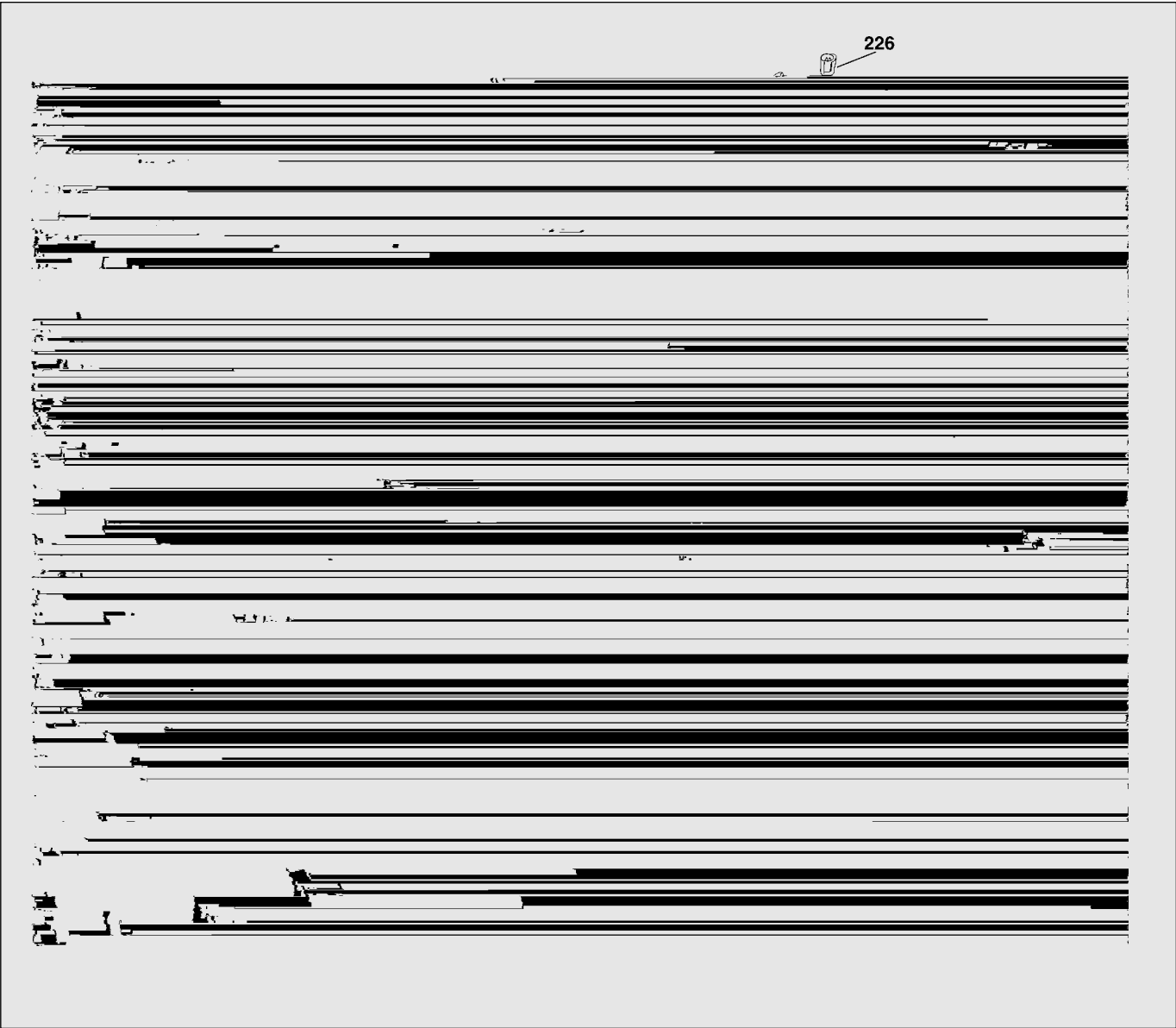

AX4S/AXOD/E

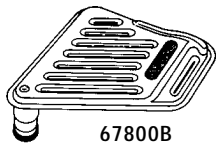

67800B
(2nd Design, Short, Orange Seal)
Short Bracket Included

67800C
(2nd Design, Long, Orange Seal)
Short Bracket Included

67800D
(Green Seal)

AXOD/E (AX4S)		
Lincoln Continental	88-Up	
Sable - Various	86-Up	
Taurus - Various	86-Up	
Taurus - SHO	91-Up	
Windstar	95-Up	

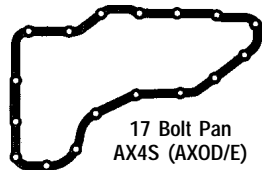

17 Bolt Pan
AX4S (AXOD/E)

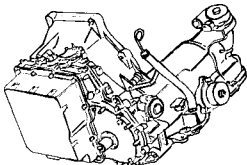

Front Wheel Drive

FORD AXOD/E (AX4S) AX4S-HO OVERDRIVE

REBUILDER KITS

DESCRIPTION	QTY.	YEAR	DELUXE KIT	MASTER O/H KIT	LESS STEELS KIT	OVERHAUL KIT	GASKET & SEAL KIT
To order Kits with all Borg Warner frictions, use a 'KB' prefix instead of the traditional 'K' prefix.							
Rebuilder Kits:							
-w/.090 Intermediate Steels - AXOD	1	86-87	K6700-R	K6700	K6700-LS	K67900	K67900-1
-w/.070 Intermediate Steels - AXOD	1	88-Up	K6700A-R	K6700A	K6700-LS	K67900	K67900-1
- AX4S (1)	1	91-95	K6700E-R	K6700E	K6700E-LS	K67900E	K67900E-1
- AX4S - Windstar 3.8L (2)	1	96-98		K6700G	K6700G-LS	K67900E	K67900E-1
- AX4S - Taurus (Windstar 3.0L) (3)	1	96-98		K6700H	K6700H-LS	K67900E	K67900E-1
- AX4S - Taurus (Windstar 3.0L) (4)	1	99-Up		K6700J	K6700J-LS	K67900J	
- AX4S - Windstar 3.8L	1	99-00		K6700L	K6700L-LS	K67900J	
External Leak Seal Kit - AXOD	1	86-Up					SK67900-2

(1) To service 91 models, purchase 4, 67304 frictions and 4, 67405 steels separately. To service 93-95 SHO, purchase direct/intermediate bonded pistons separately.

(2) Master overhaul kit/less steels kits contain forward "short"/direct/intermediate bonded pistons for replacement/conversion, and hi-energy friction/Kolene steels for direct/intermediate clutch. To service 1998 Windstar, purchase forward piston, 67946E, separately. To service any 3.0L/3.8L direct/intermediate with .095 thick steels, purchase 67305AK separately.

(3) Master overhaul kit & less steels kit does not contain bonded pistons. Friction/steel make-up same as "G" kit.

(4) Direct/intermediate steels are .070 thick. To service models with .095 direct/intermediate steel purchase 67305AK separately.

ILL.	DESCRIPTION	QTY.	YEAR	PART NO.	REFERENCE NO.
VALVE BODY KITS					
	TRANSGO®				
N.I.	Shift Kit® - Lube & Calibration Upgrade - AXOD	1	86-Up	K67908	SK® AXOD
N.I.	Shift Kit® - Corrects Lube, Shift, Line, & EPC Problems - AX4S	1	91-Up	K67908E	SK® AXOD-E
N.I.	Shift Kit® - Corrects Lube, Shift, Line, & EPC Problems - AX4S	1	96-Up	K67908EJ	SK® AXODE-JR
	SUPERIOR				
N.I.	Shift Correction Package - Cleaner Shifts, Better Lube Oil - AXOD	1	86-Up	67C01	K-AXOD
N.I.	Shift Correction Package - Inc. New Steel Boost Valve Replacement - AXOD-E	1	91-Up	67C02	K-AXOD-E
N.I.	Lub Dam Kit - Retains Oil In Case, Protects Against Planet Burn Up - AXOD/E	1	86-Up	K67836	KAXOD-L
	SONNAX				
N.I.	Sure Cure® - Recondition Kit - AXOD-E - Fixes Downshift, Harsh Reverse	1	91-Up	67S02	SC-AXODE

MISCELLANEOUS GASKETS & SEALS/PAN GASKETS

1G	Gasket - Oil Pan:				
	- Cork & Neoprene	1	86-95	13995X	E6DZ-7A191A
	- Fibre	1	86-95	13995F	E6DZ-7A191A
	- Korkcork	1	86-95	13995S	E6DZ-7A191A
	- Molded Rubber	1	96-Up	13995R	F6DZ-7A191A
2F	Gasket - Main Control Cover - Side:				
	- Cork/Neoprene	1	86-95	13935	E6DZ-7F396A
	- Fibre	1	86-95	13935F	E6DZ-7F396A
	- Korkcork	1	86-95	13935S	E6DZ-7F396A
	- Molded Rubber	1	96-Up	13935R	F6DZ-7F396A
3F	Gasket - Chain Cover:				
	- AX4S	1	86-99	13936	E6DZ-7G303A
	- AX4S	1	00-Up	13936B	YF1Z-7G303AA
4F	Gasket Package -Pump/Valve Body:				
	- No Stripe - AXOD (7)	1	86	K13812	N.L.
	- White Stripe - AXOD (7)	1	87	K13812A	N.L.
	- Yellow/Blue Stripe - AXOD (7)	1	88-91	K13812B	N.L.
	- Various Stripes - AXOD-E (7)	1	91-Up	K13812D	N.L.

(7) Contains oil pump and V.B. separator plate gaskets. 94-Up uses bonded gaskets to separator plate

FORD AXOD/E (AX4S) AX4S-HO OVERDRIVE

ILL.	DESCRIPTION	QTY.	YEAR	PART NO.	REFERENCE NO.
MISCELLANEOUS GASKETS & SEALS/PAN GASKETS					
5F	Gasket - Valve Body - Bonded w/Plate: - #31 - 3.2L - Taurus SHO - AX4S - #40 - 3.0L - Taurus, Sable - AX4S - #41 - 3.8L - Continental (94), Taurus, Sable - AX4S - #58 - 3.8L - Windstar - AX4S - #53 - 3.0L - Windstar - AX4S - #42 (Replaces #63 & #97) - 3.0L - Windstar, Taurus, Sable - AX4S - #47 - 3.8L - Windstar - AX4S (Replaces #67) - #98 - 3.0/3.8L - Taurus, Sable, Windstar - AX4S - #95 - 3.0/3.8L - Taurus/Sable/Windstar - AX4S (Replaces #94 & #99) - #00 - 3.0L - Taurus, Sable - AX4S	1 1 1 1 1 1 1 1 1 1	94-95 94-95 94-95 95 95 96-97 96-97 98 99-00 00	13813H 13813J 13813K 13813L 13813M 13813N 13813P 13813Y 13813AB 13813AC	F5DZ-7Z490B F5DZ-7Z490C F5DZ-7Z490D F58Z-7Z490A F58Z-7Z490B F6DZ-7Z490FB F68Z-7Z490CA F88Z-7Z490AA XF2Z-7Z490BA YF1Z-7Z490AA
6F	Gasket - Pump - Bonded w/Plate - AX4S: - #AH - 3.8L - Continental (94), Windstar (95), All Engines-Taurus, Sable, SHO - #51 - 3.0L - Windstar, All Engine Sizes - Taurus, Sable, Windstar - #99 - 3.0/3.8L - Taurus, Sable, Windstar	1 1 1	94-95 95-98 99-00	13813Q 13813R 13813S	F5DZ-7R167A F58Z-7R167A XF2Z-7R167AA
9G	Sleeve - Oil Filler Tube to Case - All	1	86-Up	13925	E2FZ-7N243A
10G	Gasket - Low & Intermediate Servo Cover - All	1	86-Up	13938	F2DZ-7D026A
11G	Seal - Overdrive Servo Cover - White Stripe - All	1	86-Up	13939	E6DZ-7D024A
	Seal - Overdrive Servo Cover - No Color - All	1	86-Up	13939A	E6DZ-7D024B
12G	O-Ring - Governor/Speedo Cover - AXOD/E	1	86-98	13940	N803201S
13F	Slide Seal - Pump - Round Rubber - All	1	86-Up	13768	N.L.
14F	Slide Seal - Pump - Plastic - All	1	86-Up	13762	N.L.
N.I.	Cap - Bonded (Governor Cover - Fits Governor/Speedo Cover Hole)	1	00-Up	13197	N.L.
N.I.	O-Ring - Low & Intermediate Servo Cover - All	1	86-Up	13817	E6DZ-7D040A
N.I.	Check Ball - 5/16" Valve Body - All	AR	86-Up	13924A	E0AZ-7E195A
N.I.	Plug Seal - Lube Tube to Case - AXOD	1	86-93	13969	E6DZ-7G085A
N.I.	Plug Seal - Lube Tube to Case - 2nd Design - AXOD-E	1	93-Up	13969F	F3DZ-7G085A
CLUTCH PLATES					
Order Frictions with 'B' prefix for Borg arner brand, 'R' prefix for Raybestos brand.					
25D	Friction - Reverse - All	4-5	86-Up	67504	F8DZ-7B164CA
28B,C	Friction - Direct & Intermediate - All	9/10	86-95	67404	E8DZ-7B164A
28B,C	Friction - Direct & Intermediate - Hi-Energy - All	9/10	96-Up	67404H	XF2Z-7B164CA
32B	Friction - Forward - AXOD/E	3/4	86-91	67304	E6DZ-7B164B
32B	Friction - Forward - 4.67 I.D.	4	92-Up	67304A	F8DZ-7B164AC
26D	Steel - Reverse - Flat - .068 - All	4	86-Up	67505	XF1Z-7B442AA
26D	Steel - Reverse - Flat - .059 - All	AR	98-Up	67505A	F80Z-7B442BA
29B	Steel - Direct - .070 - All	4/5	86-Up	67405	E6DZ-7B442A
29B	Steel - Direct - Kolene	4/5	86-Up	67405K	F50Z-7B442C
29C	Steel - Intermediate: - .090 - AXOD - .070 - All - .070 - Kolene - All - .095 - All - .095 - Kolene - All	5 5 5 5 4/5	86-87 88-Up 86-Up 86-Up 97-Up	67305 67405 67405K 67305A 67305AK	E6DZ-7B442B E6DZ-7B442A F50Z-7B442C XF2Z-7B442BA F7DZ-7B442BA
33B	Steel - Forward: - .070 - Small I.D. - AXOD/E - .070 - Kolene - AXOD/E - .069 - Large I.D. - All - .069 - Large I.D. - Kolene - All	3/4 3/4 4 4	86-91 86-91 92-Up 92-Up	67405 67405K 67405A 67405AK	E6DZ-7B442A F50Z-7B442C XF1Z-7B442BA N.L.
CUSHION SPRINGS					
27D	Reverse Cushion Spring - 4 51/64" I.D. - All	1	86-Up	67715	E6DZ-7E085A
31C	Intermediate Cushion Spring: - .067 - 20T - All - .071 - 8T - All	1 1	88-Up 90-Up	67715A 67715C	E8DZ-7E085A F50Z-7E085BA

AX4S/AXOD/E

FORD AXOD/E (AX4S) AX4S-HO OVERDRIVE

ILL.	DESCRIPTION	QTY.	YEAR	PART NO.	REFERENCE NO.
CLUTCH PLATES (cont.)					
N.I. 34B	CUSHION SPRINGS (cont.) Intermediate Clutch Spacer - 3.0L - All Forward Cushion Spring: - .067 - 20T - All - .073 - 20T - All - .083 - AXOD-E	1 1 1 1	88-Up 86-91 90-91 92-Up	67716 67715A 67715D 67715E	E8DZ-7B437A E8DZ-7E085A F0DZ-7E085A F2DZ-7E085A
PRESSURE PLATES					
37D 38B	Reverse - .203 Thick - 54T - 4-25/32" I.D. - All Direct: - .160 Thick - 34T - All - .130 Thick - 34T - All	1 1 1	86-Up 86-Up 93-Up	67714 67714A 67714H	E6DZ-7B066D E6DZ-7B066A F5DZ-7B066A
39C	Intermediate: - .200 Thick - 34T - AXOD - .120 Thick - 34T - AXOD/E	1 1	86-87 88-Up	67714B 67714C	E6DZ-7B066B E8DZ-7B066A
40B	Forward: - .280 Thick - 34T - 4-23/32" I.D. - AXOD - .280 Thick - 34T - 4-15/16" I.D. - AXOD-E - .170 Thick - 34T - 4-15/16" I.D. - SHO	1 1 1	86-91 92-Up 93-Up	67714D 67714E 67714G	E6DZ-7B066C F2DZ-7B066A F3DZ-7B066A
FILTERS/FILTER KITS					
Order Filter Kits with 'FK' prefix for Cork & Neoprene, 'FFK' prefix for Fibre.					
N.I. 42G	Filter Kits: - 2nd Design - Cork Type w/Short Bracket - w/67800B Filter - Exc. SHO - 2nd Design - Cork - w/67800C - SHO AX4S - Molded Rubber - w/67800D - AX4S Filter: - 2nd Design - Short Orange Seal - All Exc. SHO - 2nd Design - Tall Orange Seal - - SHO - Green Seal - AX4S Exc. SHO/95-Up Lincoln	1 1 1 1 1 1 1	86-95 92-95 96-Up 86-95 92-Up 96-Up 86-Up	FK67800B FK67800C FK67800D 67800B 67800C 67800D 67712	N.L. N.L. N.L. E6DZ-7A098A F3DP7G186AB F6DZ-7A098A E6DZ-7G308A
N.I. N.I.	Screen - Bypass Solenoid Screen - Chain Cover - 1-2 Servo	1 1	86-Up 89-98	67712 67712A	E6DZ-7G308A E9DZ-7H162A
BRAKE BANDS					
Order NE Brake Bands with 'B' prefix for Borg arner brand, 'R' prefix for Raybestos brand.					
44E 45A 49A	Low/ Intermediate - Split Type: - AX4S - AX4S - Relined - Mercon Required - AX4S - Mercon "5" Required - AX4S Overdrive - Flex Type - All Overdrive Band Anchor Plug - All	1 1 1 1 1 1	86-95 86-95 95-97 98-Up 86-Up 86-Up	67320 67320-RL 67320A 67320B 67520 67611	F4DZ-7D034A E6DZ-7D034A F48Z-7D034AA F8DZ-7D034AA E6DZ-7F196A E6DZ-7D430A
METAL CLAD SEALS					
46G 47G 48G N.I.	Converter Impeller Hub - All Differential Axle - Left & Right - All Manual Control Shaft - All Pump Shaft Seal - All	1 2 1 1	86-Up 86-Up 86-Up 86-Up	67200 67201 67202 67203	E6DZ-7F401A E6DZ-1177A E6DZ-7F337A E6SP-7N089

FORD AXOD/E (AX4S) AX4S-HO OVERDRIVE

ILL.	DESCRIPTION	QTY.	YEAR	PART NO.	REFERENCE NO.
BUSHINGS/BEARINGS					
N.I.	Bushing Kit - Complete:				
	- All (8)	1	86-93	K67901	N.L.
	- w/2nd Design Sun Gear - All (9)	1	93-Up	K67901A	N.L.
N.I.	Converter Hub:				
	- Bronze - All	1	86-Up	67001	E6SP-7N805AB
	- Babbit - All	1	86-Up	67001B	N.L.
51G	Stator Support - All	1	86-Up	51008	N.L.
52D	Front Planet Carrier - Original Type - All	1	86-91	67003	E6SP-7G220AA
	Front Planet Carrier - To Replace Bore Bearing 67003B - Brass - Only OEM Planet	1	91-Up	67003X	N.L.
53C	Sun Gear Shell:				
	- w/Small O.D. - 1.590 - All	2	86-92	67004	E6SP-7F209AA
	- w/Large O.D. - 1.620 - All	1	93-Up	67004A	N.L.
	- To Replace Planet Shaft Bearing 67004B	1	93-Up	67004X	N.L.
54E	Sun Gear Drum:				
	- w/Small - O.D. - 1.980 - All	1	86-Up	67005	E6SP-7D065AA
	- w/Large - O.D. - 2.005 - All	1	93-Up	67005A	N.L.
55E	Sun Gear Drum Support (1 Long Bushing) - All	1	88-Up	67006A	E7DP-7A132AA
56E	Final Drive Sun Gear Assembly - All	1	86-Up	67007	E6SP-7G344AA
57C	Direct Intermediate Clutch Drum - All	1	86-Up	67008	E6SP-7G123AA
58A	Driven Sprocket Support - All	1	86-Up	67009	E6SP-7G170AA
59B	Direct Overrun Clutch Cam:				
	- Narrow - .560 - All Exc. SHO / Windstar 3.8L	1	86-Up	67011	E6SP-7G138AB
	- Wide - .660 - SHO / Windstar 3.8L	1	94-Up	67011A	F3SP-7G138AA
60G	Case - All	1	86-Up	67012	E6SP-7E110AA
61A	Overdrive Drum - All	1	86-Up	67013	E8DP-7G210AA
62D	Rear Planet Carrier - All	1	86-Up	67014	E6SP-7B375A
BEARINGS					
52D	Bore Bearing - Front Planet Carrier	1	91-Up	67003B	N.L.
53C	Shaft Bearing - Front Planet	1	93-Up	67004B	N.L.
103F	Oil Pump Shaft Bearing Assembly - Small O.D. 1.00 - All	1	86-00	67922	N.L.
	Oil Pump Shaft Bearing Assembly - Small O.D. 1.00 - AX4S w/intergral seal	1	01-Up	67922A	N.L.
(8) K67901 contains all required bushings including 67004, 67005. (9) K67901A contains all required bushings including 67004A, 67005A. For wide direct cam models, must purchase 67011A separately.					
SEALING RINGS/RING KITS					
Order Sealing Rings with 'T' suffix for Teflon.					
N.I.	Sealing Ring Kit - All	1	86-Up	K67903	N.L.
63G	Turbine Shaft - Rear 1.003 O.D. - All	1	86-Up	67300	E6DZ-7G090A
64G	Turbine Shaft - Front 1.108 O.D. - All	1	86-Up	67308	E6DZ-7G091A
65G	Front Pump Shaft - Rear - .833 O.D. - Scarf Cut - All	2	86-Up	67309	E6DZ-7G092A
66G	Front Pump Shaft - Front - .693 O.D. - Scarf Cut - All	2	86-Up	67306	E6DZ-7G093A
67F	Pump Slide Ring - Solid - All	1	86-Up	67302	E6DZ-7G281A
68F	Pump Rotor Vane Ring - Solid(not in kit) - All	2	86-Up	67303	E6SP-7G287
69A	Forward & Direct Clutch Cylinder - 2 Forward, 3 Direct - All	5	86-Up	67301	E6DZ-7D019A
N.I.	Governor - AXOD	1	86-Up	67307	E6SP-7G174AB
THRUST WASHERS/NEEDLE BEARINGS					
N.I.	Washer Kit - w/o Selectives - All	1	86-95	K67907	N.L.
N.I.	Washer Kit - w/o Selectives - All	1	96-Up	K67907A	N.L.
70B	Direct Clutch Thrust - 4.181 O.D. x .061 Thick - All	1	86-Up	67210	F2DZ-7F369A

FORD AXOD/E (AX4S) AX4S-HO OVERDRIVE

ILL.	DESCRIPTION	QTY.	YEAR	PART NO.	REFERENCE NO.	
THRUST WASHERS/NEEDLE BEARINGS (Cont.)						
71A	Forward Clutch Thrust - 4.330 O.D. - 6 Grooves - All	1	86-Up	67211	E6DZ-7A166A	
72A	Driven Sprocket Thrust - 3-7/32" O.D. x .050 Thick - 3 Tabs - All	1	86-Up	67212	E6DZ-7G115A	
73A	Driven Sprocket Support Thrust - Rear Selective - Fibre - Small:					
	- .056 - .062 Natural - All	AR	86-Up	67400	E6DZ-7G273A	
	- .064 - .070 Green - All	AR	86-Up	67400A	E6DZ-7G273B	
	- .076 - .080 Blue - All	AR	86-Up	67400B	E6DZ-7G273C	
	- .085 - .089 Red - All	AR	86-Up	67400C	E6DZ-7G273D	
74A	Driven Sprocket Support Thrust - Front Selective - Plastic - Large:					
	- .088 Green - All	AR	86-Up	67409	E6DZ-7D014A	
	- .098 Black - All	AR	86-Up	67409A	E6DZ-7D014B	
	- .107 Natural - All	AR	86-Up	67409B	E6DZ-7D014C	
	- .117 Red - All	AR	86-Up	67409C	E6DZ-7D014D	
75F/G	Drive Sprocket Thrust - Front & Rear:					
	- 2-47/64" O.D. - 9 Oil Grooves - All	2	86-95	67213	E6DZ-7G099A	
	- 2-47/64" O.D. - 9 Oil Grooves - All	2	96-Up	67213A	F5DZ-7G099A	
76F	Chain Cover Thrust:					
	- 3" O.D. - 3 Tabs - 6 Oil Grooves - All	1	86-95	67214	E6DZ-7G096A	
	- 3" O.D. - 3 Tabs - 6 Oil Grooves - Plastic - All	1	96-Up	67214A	F5DZ-7G096A	
N.I.	Washer Kit - (Use w/SPS112A, See Index) - Front Or Rear Planet Assembly	1	-	QWK2320	N.L.	
BEARINGS						
N.I.	Bearing Kit - All Exc. SHO (Contains Most SHO Bearings)	1	86-Up	K67906	N.L.	
80E	Differential Carrier/Case Bearing & Race Assembly - All	1	86-Up	67220	E6DZ-7G112A	
81E	Final Drive - Carrier/Sun Gear - All	1	86-Up	67221	E6DZ-7F404A	
82E	Park/Final Drive Support - All	1	86-Up	67222	E6DZ-7F405A	
83C	Intermediate Clutch Hub - Front & Rear Bearing & Race Assembly - All	2	86-Up	67224	E6DZ-7C096A	
84E	Rear Sun Gear Bearing & Race Assembly - Rear - 3 Piece Design - All	1	86-Up	36444C	E6DZ-7G178A	
85A	Direct Clutch Hub Bearing & Race Assembly - All	1	86-Up	67225	E6DZ-7F240A	
86D	Front/Rear Planet - 2-39/64" O.D. - All	1	86-Up	67226	E6DZ-7G177A	
87G	Governor Bearing & Race Assembly - 1.068" O.D. - All	1	86-Up	51466A	E6DZ-7G173A	
N.I.	Front Planet - Captured- All	1	86-Up	67228	N.L.	
N.I.	Rear Planet - Captured - All	1	86-Up	67229	N.L.	
SHI S						
77E	Differential Carrier Thrust - Selective:					
	- .049 Red - All	AR	86-Up	67401	F2DZ-7G103A	
	- .053 Green - All	AR	86-Up	67401A	F2DZ-7G103B	
	- .057 Blue - All	AR	86-Up	67401B	F2DZ-7G103C	
	- .061 Black - All	AR	86-Up	67401C	F2DZ-7G103D	
	- .065 White - All	AR	86-Up	67401D	F2DZ-7G103E	
	- .072 Gold - All	AR	86-Up	67401F	F2DZ-7G103G	
HARD PARTS						
Hard Parts may only require the base number for OE /Aftermarket New. A "N" suffix may also be required or a "-R" suffix for remanufactured. Exceptions are listed individually.						
NOTE: A separate column is provided to indicate a primary or specific brand/type.						
ILL.	DESCRIPTION	BRAND	QTY.	YEAR	PART NO.	REFERENCE NO.
98F	Pump Cover - All		1	86-Up	67924	N.L.
99F	Rotor		1	86-Up	67802	N.L.
	Slide		1	86-Up	67803	N.L.
	Rotor / Slide / Vane Kit		1	86-Up	K67801	N.L.
	Pump Vane Kit - All		1	86-Up	K67805	N.L.

FORD AXOD/E (AX4S) AX4S-HO OVERDRIVE

ILL.	DESCRIPTION	BRAND	QTY.	YEAR	PART NO.	REFERENCE NO.
HARD PARTS (Cont.)						
100F	Front Pump Assembly:					
	- 1986 Only AXOD	R	1	86	67920	N.L.
	- 1987 Only AXOD	R	1	87	67920A	N.L.
	- 9 Ball - 3.0L Engine - AXOD	R	1	88-90	67920B	N.L.
	- 10 Ball - 3.8L Engine - AXOD	R	1	88-90	67920C	N.L.
	- Taurus - AXOD-E	R	1	91	67920D	N.L.
	- Lincoln - AXOD-E	R	1	91-99	67920E	E8DZ-7A103B
	- Taurus - AXOD-E	R	1	92-99	67920F	N.L.
101G	Oil Pump Drive Shaft Assembly - 17-18 Spline - All		1	86-Up	67921	2F2Z-7B328AA
	Oil Pump Drive Shaft Assembly - 17-18 Spline (OEM) - All		1	86-Up	67921F	2F2Z-7B328AA
102F	Drive Chain Assembly:					
	- 3/4" Wide - 43 Links - Round Pin		1	86-Up	67973	E6DZ-7G249A
	- 7/8" Wide - 43 Links - Round Pin		1	86-88	67973A	E8DZ-7G249A
	- 3/4" Wide - 43 Links - Rocker Pin		1	93-Up	67973B	4F1Z-7G249AA
	- 3/4" Wide - 44 Links - Round Pin - Windstar 3.8L		1	95-Up	67973D	F68Z-7G249A
103F	Oil Pump Shaft Bearing Assembly - Small O.D. 1.00 - All		1	86-00	67922	N.L.
	Oil Pump Shaft Bearing Assembly - Small O.D. 1.00 - AX4S w/intergral seal		1	01-Up	67922A	N.L.
104G	Drive Sprocket Bearing - Caged - All		1	86-Up	67979	E6DZ-7G233A
107G	Converter Stator Support:- 1st Design - All (replaced by 67976A/67213A)	R	1	86-95	67976	E6DZ-7A108A
	Converter Stator Support:- 2nd Design - All (Use w/2nd Design Washer)		1	86-Up	67976A	F6DZ-7A108AA
109A	Driven Sprocket Bearing Assembly - Caged 2-5/8" O.D. x 3/4" - All		1	86-Up	67978	E6DZ-7G247A
110D	Planetary Package:- 6 Lug Shell - All		1	86-94	K67960	N.L.
	Planetary Package:- 36 Lug Shell - All		1	93-Up	K67960B	N.L.
	Planetary - Front:- 1st Design - w/o O.D. Bearing	R	1	86-93	67950	F1DZ-7A398A
	Planetary - Front:- All (Use w/67948A To Retro To '86)		1	94-Up	67950A	F5DZ-7A398BA
111D	Planet Assembly - Rear:					
	- All - 33 Spline		1	86-01	67951	F5DZ-7D006BA
	- All - 45 Spline		1	01-Up	67951D	1F1Z-7D006AB
	All - 45 Spline - w/ Final Drive Sun Gear		1	86-Up	K67951D	1F1Z-7D006BA
112D	Rear Ring Gear - All		1	86-Up	67952	E6DZ-7A153A
113E	Rear Sun Gear & Drum Assembly: - All		1	86-Up	67955	F6DZ-7A626AA
114E	Rear Planet Support: - All		1	86-92	67965	E6DZ-7A130A
	Rear Planet Support: - AXOD-E		1	93-Up	67965A	XF2Z-7A130AA
114E	Planet Support Kit - AXOD-E (11)		1	91-Up	K67965A	N.L.
115E	Final Drive Sun Gear Assembly:					
	- 30T - 33 Spline - All	R	1	86-01	67970	F3DZ-7F342B
	- 30T - 45 Spline - All (Mid 01)		1	01	67970A	1F1Z-7F342BA
	- 29T - 45 Spline - All		1	01-Up	67970C	N.L.
116E	Final Drive Planet & Carrier Assembly - All	R	1	86-01	67980	1F1Z-7F465BA
117E	Final Drive Ring Gear - 17 External Lugs - All	R	1	86-01	67985	F4DZ-7F343A
118A	Overdrive Drum w/Sprag:- Small Race - 6 Lug - AXOD	R	1	86-91	67945	E6DZ-7L669A
	Overdrive Drum w/Sprag:- Large Race - 6 Lug - AXOD-E	R	1	92-95	67945A	N.L.
	Overdrive Drum - 36 Lug - All		1	93-Up	67945B	F5DZ-7L669BA
	Overdrive Drum Assembly:- w/Shell & Narrow Direct Cam (12)	R	1	86-Up	K67945	F5DZ-7L669A
	Overdrive Drum Assembly:- w/Shell & Wide Direct Cam	R	1	95-Up	K67945B	F5DZ-7L669C
119A	Sprag - Low Clutch -26 Sprags - .594 Wide - All		1	86-Up	67930	E6DZ-7A089A
120A	Low Clutch Sprag Race		1	92-Up	67931A	F3DZ-7D171AB

(11) Contains 2nd Design support and 2nd Design crossover tube, 67988A. Must purchase 67989 separately for non-crossover AXOD-E.

(12) Components are of the 36 drive lug design. Must be used in sets. K67945 will retro to 1986 and has a narrow direct cam. Wide direct cam models use K67945B.

FORD AXOD/E (AX4S)

AX4S-HO OVERDRIVE

ILL.	DESCRIPTION	BRAND	QTY.	YEAR	PART NO.	REFERENCE NO.
HARD PARTS (Cont.)						
121B	Forward Clutch Piston:					
	- Steel - Tall - 1.040" Height - AX4S		1	86-Up	67946S	F4DZ-7A262A
	- Steel - Short - .890" Height - AX4S SHO		1	93-95	67946B	F4DZ-7A262B
	- Bonded Rubber - Short - .825" Height - All		1	96-97	67946R	F8DZ-7A262AB
	- Bonded Rubber - Tall - .980" Height - All		1	98-Up	67946E	F88Z-7A262AA
122B	Roller - Direct Clutch - Blue Plastic - .500 Wide		1	86-Up	67940	F3DZ-7A089CA
122B	Roller - Direct Clutch - Gray Plastic - .590 Wide		1	93-Up	67940A	F3DZ-7A089B
123B	Cam - Direct Roller Clutch - 6 Lug - Narrow Design	R	1	86-94	67941	N.L.
	Cam - Direct Roller Clutch - 36 Lug - Narrow Design		1	95-Up	67941A	F5DZ-7G156C
	Cam - Direct Roller Clutch - 36 Lug - Wide Design		1	93-Up	67941B	F5DZ-7G156A
124B	Direct Overrun Clutch Outer Race:- 54T - 9 Oil Holes - Narrow		1	86-Up	67942	E6DZ-7D171B
124B	Direct Overrun Clutch Outer Race:- 54T - 9 Oil Holes - Wide		1	93-Up	67942B	F5DZ-7D171A
125C	Direct Clutch Piston: - Aluminum - w/o Piston Ring - All		1	86-Up	67947	E6DZ-7A262A
	Direct Clutch Piston: - Bonded - w/o Piston Ring - All		1	94-Up	67526	F4DZ-7A262BA
	Direct Clutch Piston Ring - (For Bonded Direct Piston)		1	94-Up	67526-1	F4DP-7G448AA
126C	Intermediate Clutch - Piston: - Steel - All		1	86-Up	67953	E6DZ-7E005A
126C	Intermediate Clutch - Piston: - Bonded - w/o Bonded Retainer - All		1	93-Up	67530	F88Z-7E005AA
127C	Intermediate Clutch - Piston Retainer - Bonded - All		1	93-Up	67531	F4DZ-7H185A
130G	Overdrive Servo Piston & Seal Assembly - Slip Fit - All		1	86-97	67528	F3DZ-7F200A
	Overdrive Servo Piston & Seal Assembly - Press Fit - All		1	98-Up	67528B	F88Z-7F200AA
	Overdrive Servo - Complete - All	R	1	86-97	K67528	N.L.
	Overdrive Servo - Complete - All	R	1	98-Up	K67528C	N.L.
131G	Overdrive Servo Rod - Selective:					
	- No Groove - Slip Fit - All		AR	86-97	67949	E6DZ-7F203A
	- 1 Groove - Slip Fit - All		AR	86-97	67949A	E6DZ-7F203B
	- 2 Groove - Slip Fit - All		AR	86-97	67949B	E6DZ-7F203C
	- w/ Piston - No Groove		AR	98-Up	67949E	F88Z-7H188AA
	- w/Piston - 1 Groove		AR	98-Up	67949F	F88Z-7H188BA
	- w/Piston - 2 Groove		AR	98-Up	67949G	F88Z-7H188CA
131G	Extendo Pins - Overdrive - All		1	86-Up	67875	N.L.
132G	Extendo Pins - Low/Intermediate - All		1	86-Up	67875A	N.L.
132G	Low/Intermediate Servo Rod - Selective:					
	- No Groove - All		AR	86-Up	67959	E6DZ-7D190A
	- 1 Groove - All		AR	86-Up	67959A	E6DZ-7D190B
	- 2 Grooves - All		AR	86-Up	67959B	E6DZ-7D190C
	- 3 Grooves - All		AR	86-Up	67959C	E6DZ-7D190D
	- 4 Grooves - All		AR	86-Up	67959D	E6DZ-7D170E
132G	Pin - Low/Intermediate Servo - Large - AXOD/E		1	86-Up	67959S	N.L.
133G	Governor Assembly - AXOD	R	1	86-Up	67615	E6DZ-7C053A
133G	Speedo Drive - AX4S		1	91-Up	67615C	F68Z-7G176AA
134G	Speedo Drive Gear - 7T - AXOD/E		1	86-Up	67650	E6SP-17285
138G	Low Servo Piston - All		1	86-Up	67986	N.L.
138G	Low/Intermediate Servo - Complete - All	R	1	86-Up	K67986	N.L.
139E	Governor Gear: - Drive - Yellow Plastic - All		1	86-Up	67981	E7DZ-7G237A
143G	Spring - Low Servo - All		1	86-Up	67707S	N.L.
148A	Reluctor Driven Sprocket: - AX4S		1	91-Up	67992	F1DZ-7H150A
150A	Driven Sprocket Support - AXOD/E		1	86-Up	67977	E6DZ-7G166A
152A/G	Drive/Driven Sprocket w/Turbine:					
	- 37T-36T - Wide - AXOD	R	1	86-87	K67984	N.L.
	- 37T-36T - Narrow - AXOD	R	1	86-90	K67984A	N.L.
	- 38T-35T - Narrow - AXOD	R	1	88-90	K67984B	N.L.
	- 38T-35T - 23 Spline - Round Pin - AXOD-E	R	1	91-93	K67984C	N.L.
	- 35T-38T - 23 Spline - Round Pin - AXODE, SHO	R	1	93	K67984E	N.L.
	- 38T-35T - 25 Spline - Rocker Pin - AXOD-E	R	1	94-Up	K67984D	N.L.
	- 35T-38T - 25 Spline - Rocker Pin - AXOD-E, SHO	R	1	94-Up	K67984F	N.L.
	- 34T-39T - Round Pin - All	R	1	95-Up	K67984H	N.L.

FORD AXOD/E (AX4S) AX4S-HO OVERDRIVE

ILL.	DESCRIPTION	BRAND	QTY.	YEAR	PART NO.	REFERENCE NO.
HARD PARTS (Cont.)						
154C	Direct/Intermediate Drum:					
	- Steel Piston Design - 13mm Spline - 3.0/3.8L - AXOD/E		1	86-E96	67963	F6DZ-7G120A
	- Bonded Piston Design - 10mm Spline - SHO		1	93-95	67963A	F3DZ-7G120A
	- Bonded Piston Design - 10mm Spline - 3.8L - AX4S		1	L96-Up	67963B	F5DZ-7G120A
	- Steel Piston Design - 10mm Spline - 3.0L - AX4S		1	L96-97	67963C	F6DZ-7G120BA
	- Steel Piston Design - 10mm Spline - 3.0L - AX4S		1	98-Up	67963D	1F1Z-7G120BA
155E	Final Drive Package w/Sun & Ring:- AXOD/E (30T Sun)	R	1	86-01	K67980	N.L.
	Final Drive Package w/Sun & Ring:- AXOD/E (29T Sun - Update)		1	86-01	K67980A	2F2Z-4207DA
157D	Reverse Drum (w/Piston Reman only)	R	1	86-Up	67962	E60Z-7F341A
158B	Forward Drum:					
	- 13mm Spline - All Exc. SHO		1	86-E96	67964	E6DZ-7A360A
	- 10mm Spline - SHO	R	1	93-95	67964C	F3DZ-7A360A
	- 10mm Spline - 3.0L - AX4S		1	L96-Up	67964A	F6DZ-7A360BA
	- 10mm Spline - 3.8L - AX4S		1	L96-Up	67964E	F5DZ-7A360A
160C	Shell - Sun Gear:					
	- 1st Design - 2 Bushings - 6 Lug - AXOD	R	1	86-91	67948	E6DZ-7D064A
	- 6 Lug - All		1	86-94	67948A	F4DZ-7D064BA
	- 36 Lug - All		1	93-Up	67948B	F5DZ-7D064A
161F	Valve Body Cover - AXOD/E	R	1	86-95	67998	N.L.
163F	Valve Body - Complete:					
	- AXOD - 1986 Only	R	1	86	67990	N.L.
	- AXOD - 1987 Only	R	1	87	67990A	N.L.
	- AXOD - 9 Ball - 3.0L	R	1	88-90	67990B	N.L.
	- AXOD - 10 Ball - 3.8L	R	1	88-90	67990C	N.L.
	- AXOD-E - Taurus	R	1	91	67990D	N.L.
	- AXOD-E - Lincoln	R	1	91-99	67990E	N.L.
	- AXOD-E - Taurus	R	1	92-99	67990F	N.L.
165C	Intermediate Hub:					
	- Medium - .970 Spline - All		1	86-Up	67944	E6DZ-7B067A
	- Short - .900 Spline - All		1	88-Up	67944A	E8DZ-7B067A
	- Long - 1.100 Spline - All		1	93-Up	67944B	1F1Z-7B067AA
170E	Park Gear - All	R	1	86-Up	67969	N.L.
175G	Oil Pan: - All	R	1	86-95	67999	N.L.
	Oil Pan: - SHO	R	1	93-95	67999A	N.L.
	Oil Pan: - All	R	1	96-Up	67999B	N.L.
177E	Axle Shaft:- 18" Long - All	R	1	86-Up	67993	N.L.
180G	Lube Tube- Crossover:					
	- 1st Design - AXOD-E		1	91-92	67988	F2DZ-7G084A
	- 2nd Design - AXOD-E		1	93-99	67988A	F3DZ-7G084A
	- 3rd Design - Single Tube Design - AXOD-E		1	99-Up	67988B	1F1Z-7G084AA
182G	Lube Tube - Differential & Speedo		1	91-Up	67989	F2DZ-7G086A
200G	Case: - AXOD/E	R	1	86-Up	67997	N.L.
205F	Case Cover:					
	- AXOD - 1986 Only	R	1	86	67995	N.L.
	- AXOD - 1987 Only	R	1	87	67995A	N.L.
	- AXOD	R	1	88-90	67995B	N.L.
	- AXOD-E - 2 Conn	R	1	91-92	67995D	N.L.
	- AXOD-E - 1 Conn	R	1	93-99	67995F	N.L.
	- AXOD-E - 1 Conn	R	1	00-Up	67995G	N.L.
N.I.	Accumulator Piston Pin		3	86-Up	67876	E6DZ-7G094A
N.I.	Accumulator Spring Kit:					
	- Complete - All		1	86-Up	K67704	N.L.
	- 1-2 - All		1	86-Up	K67705	N.L.
	- 3-4 - All		1	86-Up	K67706	N.L.

AX4S/AXOD/E

FORD AXOD/E (AX4S) AX4S-HO OVERDRIVE

ILL.	DESCRIPTION	BRAND	QTY.	YEAR	PART NO.	REFERENCE NO.
HARD PARTS (Cont.)						
N.I.	Accumulator Spring:					
	- 1-2 - Large Yellow - All		1	86-Up	67705	E6DZ-7G267A
	- 1-2 - Large Brown - All		1	88-Up	67705A	E8DZ-7G267A
	- 1-2- Medium - Brown, Purple, Pink - All		1	88-Up	67705B	E8DZ-7G358A
	- 1-2 - Medium Yellow - All		1	86-Up	67705C	E6DZ-7G326A
	- 1-2- Small Brown or Purple - All		1	88-Up	67705D	E8DZ-7G326A
	- 3-4 - Large Green - All		1	86-Up	67706	E6DZ-7G266A
	- 3-4 - Large White - All		1	89-Up	67706A	F8DZ-7G266AA
	- 3-4 - Small - Green - All		1	86-Up	67706B	E6DZ-7F288A
	- Neutral Drive - Large - Orange - All		1	86-Up	67707	E6DZ-7G300A
	- Neutral Drive - Small - Blue - All		1	86-Up	67707A	E6DZ-7G301A
N.I.	Lube Dam Kit - All		1	86-Up	K67836	KAXOD-L
N.I.	Lube Sleeve - Planet - Aluminum - All		1	86-Up	67910	N.L.
N.I.	Servo Piston "E" Clips - Overdrive - AXOD/E		1	86-97	67957	97413-S
N.I.	Servo Piston "E" Clips - Low/Intermediate - AXOD/E		1	86-Up	67958	N804195-S2
N.I.	Servo Split Clip - Low/Intermediate - (Replaces OE "E" Clips)		1	86-Up	67958S	N804195-S2
N.I.	Retaining Ring - Rear Ring Gear - AXOD/E		1	86-Up	67954S	N.L.
N.I.	Sleeve - w/Piston - Accumulator:					
	- 1-2 Accumulator		1	86-Up	K67877	N.L.
	- 3-4 Accumulator		1	86-Up	K67877A	N.L.
	- N/D Accumulator		1	86-Up	K67877B	N.L.
N.I.	Bracket - Servo Tube - AXOD/E		1	86-Up	67987	N.L.
VALVE BODY COMPENENTS						
N.I.	Valve Spring - 1-2 Capacity - AXOD		1	86-Up	K67975	N.L.
N.I.	Valve/Spring Retainer:					
	- 3/2 - AX4S		1	91-Up	67961	F1DZ-7F194A
	- Flat- Various - AX4S		1	91-Up	67961E	N.L.
	- Double Loop - Various - AX4S		1	91-Up	67961F	N.L.
	- Single Loop - Various - AX4S		1	91-Up	67961G	N.L.
N.I.	Valve Body to Pump Shaft Sleeve - All		1	86-Up	67641	N.L.
N.I.	Boost Valve/Sleeve - .491 - AXOD/E		1	86-Up	K67971	N.L.
N.I.	Boost Valve/Sleeve - .475 - AXOD/E		1	86-Up	K67971B	N.L.
N.I.	Valve - w/Sleeve: - Converter Clutch - Bypass - AXOD		1	86-Up	K67967B	N.L.
N.I.	Valve - w/Sleeve: - Converter Clutch - Bypass - AXOD-E		1	91-Up	K67967	N.L.
N.I.	Forward Clutch Valve - AX4S (Use Reamer T-9126)		1	91-Up	K67979A	N.L.
N.I.	Manual Control Valve - AXOD/E		1	86-Up	67972	N.L.
ELECTRICAL PRODUCTS						
140F	Solenoid:					
	- Bypass (L/U) Clutch - AXOD		1	86-Up	5A-250	E6DZ-7G136A
	- Bypass (L/U) Clutch - Universal - Rostra - AXOD		1	86-Up	5R-257	E6DZ-7G136A
	- Bypass (L/U) Clutch - Universal - Teckpak - AXOD		1	86-Up	5T-257	E6DZ-7G136A
	- L/U - Models E, ME - Square On/Off Type - AXOD-E		1	91	5A-257	F1DZ-7G136A
	- L/U - Models E, ME - Universal - Rostra - AXOD-E		1	91	5R-257	F1DZ-7G136A
	- L/U - Models E, ME - Universal - Teckpak		1	91	5T-257	F1DZ-7G136A
	- L/U - Round PWM - White Connector - All Exc. 91 E/ME - Low Ohms		1	91-97	5A-257A	F3DZ-7G136A
	- L/U - Round PWM - White Connector - All Exc. 91 E/ME - Rostra		1	91-97	5R-257A	F3DZ-7G136A
	- L/U - Round PWM - White Connector - All Exc. 91 E/ME - Teckpak		1	91-97	5T-257A	F3DZ-7G136A
	- L/U - Round PWM - Blue Connector - High Ohms		1	97-Up	5A-257B	F7OZ-7G136AA
141F	Solenoid - Pressure Control - AXOD-E		1	91-Up	5A-258	F6DZ-7G383BB

FORD AXOD/E (AX4S) AX4S-HO OVERDRIVE

ILL.	DESCRIPTION	QTY.	YEAR	PART NO.	REFERENCE NO.
ELECTRICAL PRODUCTS					
142F	Solenoid - Shift:				
	- All	3	91-Up	5A-259	F6DZ-7G484BB
	- All - Rostra	3	91-Up	5R-259	F6DZ-7G484BB
	- All - Teckpak	3	91-Up	5T-259	F6DZ-7G484BB
N.I.	Switch - Manual Lever Position:				
	- AXOD - 6 Pin - (From 11/87)	1	88-Up	15A-125	E8DZ-7A247A
	- AXOD-E - 8 Pin - Update Package (6 Pin to 8 Pin)	1	91-92	15A-126	F2DZ-7A247A
	- AXOD-E - 8 Pin - (95-98 Windstar)	1	93-97	15A-127	F5DZ-7F293BA
	- AXOD-E - 10 Pin - (99-Up Windstar)	1	98-02	15A-128A	F8DZ-7F293AB
N.I.	Switches:				
	- 4/3 Converter By-Pass Oil Pressure - AXOD	2	86-Up	15A-243	E6DZ-7E440A
	- Oil Pressure - All	1	86-Up	15A-244	E6DZ-7E440B
N.I.	Sensors:				
	- Transmission Oil Temperature (TOT) - All	1	91-Up	20A-104	F1DZ-7H141A
	- Turbine Speed - All	1	91-Up	20A-105	F1DZ-7M101A
N.I.	Sensors - VSS - Cable/Non-Cable Design:				
	- (Speedo) - w/Cable - AXOD	1	86-90	20A-412	E9TZ-9E731A
	- (Speedo) - w/o Cable - AXOD	1	86-90	20A-412A	E9LZ-9E731A
	- (Speedo) - w/Cable - AX4S	1	91-98	20A-412	E9TZ-9E731A
	- (Speedo) - w/o Cable - AX4S	1	94-98	20A-412A	E9LZ-9E731A
	- (Output) - AX4S	1	99-Up	20A-109	XF2Z-7H103AA
225F	Case Connector w/Wires:				
	- 3.0L Engine - AXOD	1	86-90	25A-110	E6DZ-7G276A
	- 3.8L Engine - AXOD	1	88-90	25A-109	E8DZ-7G276A
225F	Case Connector - Side Mount - AXOD-E	1	91-92	25A-113	F1DZ-7G276A
226F	Case Connector:				
	- Top Mount - AXOD-E	1	91-92	25A-113A	F1DZ-7G276B
	- Side/Top Replacement - All	1	93-Up	25A-113C	F5DZ-7G276B
N.I.	Wiring Harness - External Repair:				
	- Case Connector - AXOD	1	86-90	35A-251	F2PZ-14A464F
	- Top Connector - AXOD-E	1	91-92	35A-252	F2PZ-14A464D
	- Side Connector - AXOD-E	1	91-92	35A-253	F2PZ-14A464E
	- Top Connector - AXOD-E	1	93-Up	35A-254	F2PZ-14A464G
	- Speed Sensor - AXOD-E	1	91-Up	35A-255	F2PZ-14A464A
	- Two Connector To Single Connector Update	1	91-Up	35A-256	F1DZ-7Z432A
MISCELLANEOUS PRODUCTS					
N.I.	Oil Tube Connector - 1/4" - 18 Male Quick-Connect - All	2	86-Up	96-208	E6VY-7D273A
N.I.	Intermediate Clutch Balance Piston Lip Seal Protector	1	-	T-1660	N.L.
N.I.	Reverse Piston Lip Seal Protector	1	-	T-1662	N.L.
N.I.	Lip Seal Installer/Protector Kit	1	-	T-2400	N.L.
N.I.	Front Clutch Loading Tool	1	-	T-2402	N.L.
N.I.	Low/Intermediate Servo Rod Tool	1	-	T-2403	N.L.
N.I.	Valve & Pump Shaft Body Guide Pins (Prevents Misalignment of Oil Pump and V.B.)	1	-	T-2407	N.L.
N.I.	Oil Pipe Seal Installer	1	-	T-2433	N.L.
N.I.	Reverse Drum & Planetary Gears Remover/Installer	1	-	T-2470	N.L.
N.I.	Valve Body Cover Pump Driveshaft-Bore Repair Tool	1	-	T-2495	N.L.
N.I.	Technical Manual - AXOD	1	-	67Y01	N.L.
N.I.	Technical Manual - AXOD Update	1	-	67Y02	N.L.
N.I.	Technical Manual - AXOD-E	1	-	67Y03	N.L.
N.I.	Reamer for K67979A	1	91-Up	T-9126	N.L.

AX4S/AXOD/E